

Classis RM 30

Classis RM 31

KONDENSATORMIKROFON
CONDENSER MICROPHONE
MICROPHONE À CONDENSATEUR

Produktinformation

Product Information

Informations de produit

1. Safety Information	10
2. Applications	10
3. Connection	10
4. Microphone Positioning	11
5. Maintenance.	11
6. Service.	11
7. Versions	12
8. Optional Accessories	12
9. Technical Specifications	12
10. Disposal	13
Frequency Response Curve	20
Polar Patterns	21
Wiring Diagrams.	22

Thank you for selecting the Classis RM 30 or RM 31 Revoluto microphone. Please take some time to read carefully through this information before using the product.

1. Safety Information

- Protect the microphone from moisture and sudden impacts. You could either injure yourself or others or damage the microphone.
- Do not blow into the microphone, you could damage the transformer. It is preferable to carry out a speech trial.

2. Applications

The Classis RM 30 | RM 31 is a modern desktop microphone which is ideal for discussions, podiums, tele/video conferencing, announcements and lecterns.

The Revoluto technology with integrated microphone capsules provides a corridor characteristic which ensures a wide range of good voice quality. Within this range up to two speakers can move freely, i.e. they can stand up or sit down, move their head and move towards or away from the microphone.

3. Connection

For example an XLR flange socket is installed into the tabletop and connected to the amplifier input (pin 1: ground, pin 2: NF+, pin 3: NF-). As an alternative there are installation and shockmounted holders available (refer to "Optional Accessories").

The microphone is connected and ready for operation.

The Classis RM 30 and RM 31 S microphones need a phantom supply of 8 - 52 V for operation.

Q Version

In order to avoid interference, we recommend that the audio and the supply to the illuminated ring are individually shielded. The Classis RM 31 Q microphone requires a voltage of 5 V for operation.

4. Microphone Positioning

When notebooks are being used, it is also necessary to consider the microphones. Notebooks should always be positioned to the side of the microphones. Otherwise, when opened, the LCD screen would obstruct the sound. This also applies to free-standing monitors. Sufficient distance is the key to the directional effect and good feedback suppression. Moreover, notebooks often have fans at the back. The noise of the fan would then be picked up by the microphone.

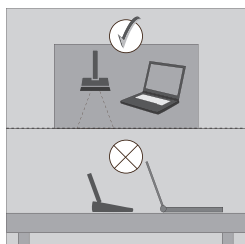

Two Classis RM 31 Q should not be directly placed back to back, because the loudspeaker of the second built-in or desktop microphone unit will be picked up by the microphone and cause feedback. The minimum distance should be 15 to 20 cm.

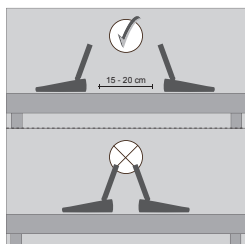

In order to avoid feedback, the minimum distance between external loudspeakers and the Classis RM 30 or Classis RM 31 should be 5 m.

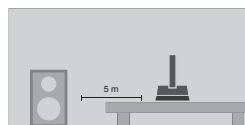

For more information about application examples, please refer to the beyerdynamic “Revolutio Design Guide”.

5. Maintenance

Use a soft, damp cloth for cleaning the microphone. If necessary, you can use a gentle cleansing agent (such as washing-up liquid). Make sure not to allow any water to enter the transducer element and never use any solvent cleansers.

6. Service

Servicing must be carried out by qualified service personnel only. Dismantling the microphone yourself will invalidate the guarantee.

7. Versions

Classis RM 30	3-pin male XLR connector, filter	Order # 729.388
Classis RM 31 S	3-pin male XLR connector, filter, LED ring, programmable switch	Order # 729.396
Classis RM 31 Q	5-pin male XLR connector, LED ring	Order # 729.302

8. Optional Accessories

GMB 33 S	Microphone base with button, 3-pin female XLR connector for Classis RM 30 and RM 31 S only	Order # 725.242
GMS 32	Shock-mounted holder for table installations, for Classis RM 30 and RM 31 S, 3-pin female XLR connector, black	Order # 729.582
GMS 52	Shock-mounted holder for table installations, for Classis RM 31 Q, 5-pin female XLR connector, black	Order # 725.757
ZSH 20	Shock-mounted holder for table installations, black	Order # 454.559

9. Technical Specifications

Microphone	Revoluto microphone array, patented
Transducer type	Electret condenser
Operating principle	Pressure gradient
Polar pattern	Corridor
Horizontal	Cardioid
Vertical	Lobe
Optimal distance to the speaker	40 - 80 cm [15.75" - 31.5"]
Frequency response	
Classis RM 31 Q	110 - 20,000 Hz
Classis RM 30	90 - 20,000 Hz
Sensitivity	28.7 mV/Pa = -30.9 dBV \pm 2 dB
Nominal impedance	
Classis RM 31 Q	< 20 Ω
Classis RM 30	< 200 Ω
Load impedance	
Classis RM 31 Q	\geq 100 Ω
Classis RM 30	\geq 1 k Ω
Signal-to-noise ratio /noise voltage	
Classis RM 31 Q	68 dB [A] / 11.5 μ V [A]
Classis RM 30	67.2 dB [A] / 12.5 μ V [A]

Max. SPL	107 dB [SPL @ 1% THD]
Equivalent SPL	26.8 dB [A]
Connector	
Classis RM 31 Q	unbalanced, 5-pin XLR male
Classis RM 30	unbalanced, 3-pin XLR male
Supply voltage / supply current	
Classis RM 31 Q	5 V / 8.5 mA (with LED)
Classis RM 30	Phantom power
	P48 (+48 VDC, 6.8 k Ω , < 4.5 mA)
	P24 (+24 VDC, 1.2 k Ω , < 4.5 mA)
	P12 (+12 VDC, 680 Ω , < 4.5 mA)
Temperature range	-10 °C bis +40 °C [14 °F to 104 °F]
Dimensions:	RM 30 RM 31 Q
Length (in mm)	261 219
[in inch].	10.28" 8.62"
Capsule \varnothing (in mm)	25 25
[in inch].	0.98" 0.98"
Weight (in g)	153 107
[in pounds].	0.235 0.377

10. Disposal

This symbol on the product, in the instructions or on the packaging means that your electrical and electronic equipment should be disposed at the end of its life separately from your household waste. There are separate collection systems for recycling in the EU. For more information, please contact the local authority or your retailer where you purchased the product.

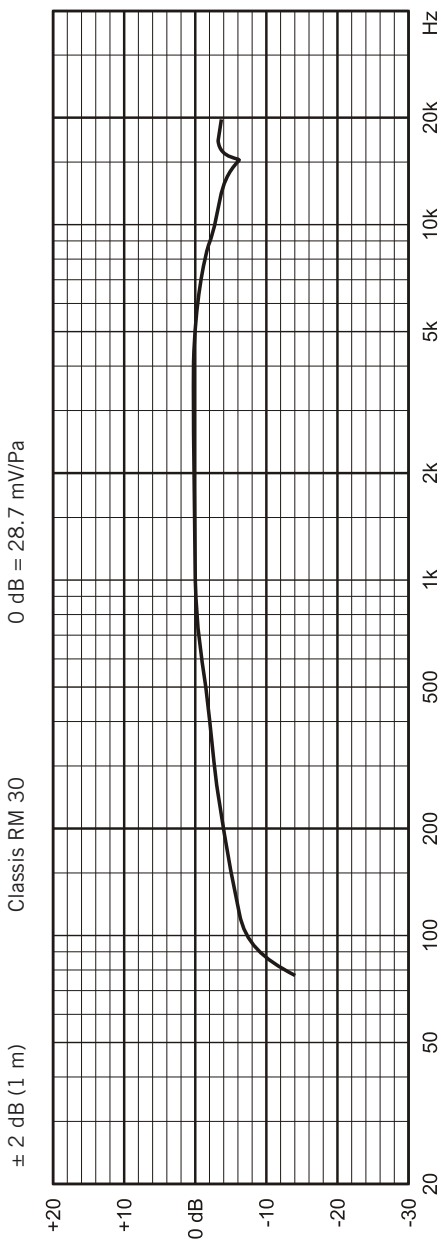

**Frequenzkurve / Frequency Response Curve /
Courbe de fréquence**

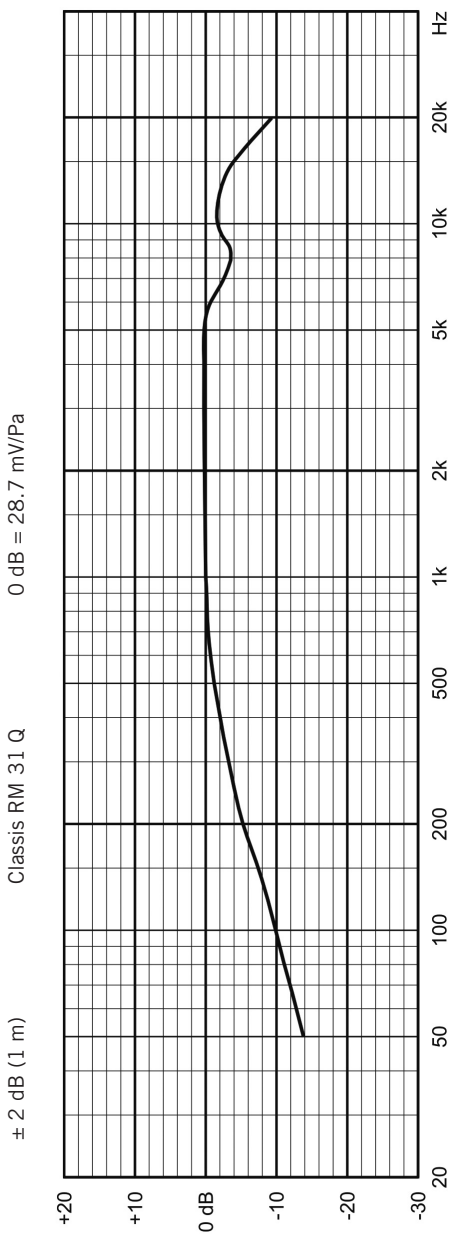

Richtdiagramme / Polar Patterns / Diagrammes de directivité

horizontal

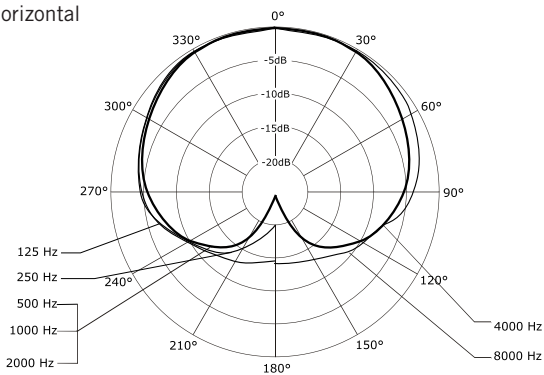

vertical

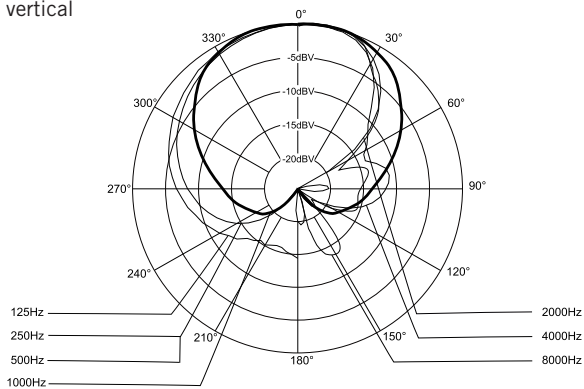

**Anschlussdiagramme / Wiring Diagrams /
Diagrammes de câblage**

Classis RM 30 | RM 31 S

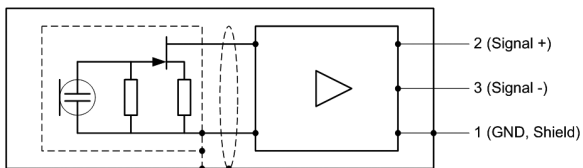

Classis RM 31 Q

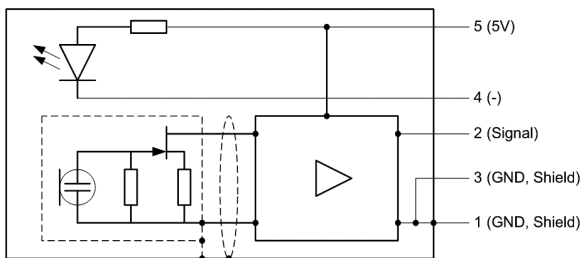

beyerdynamic GmbH & Co. KG
Theresienstr. 8 | 74072 Heilbronn – Germany
Tel. +49 (0) 7131 / 617 - 0 | Fax +49 (0) 7131 / 617 - 204
info@beyerdynamic.de | www.beyerdynamic.com

Weitere Vertriebspartner weltweit finden Sie unter www.beyerdynamic.com
For further distributors worldwide, please go to www.beyerdynamic.com

